



**HONORS PROGRAM
UNIVERSITY OF HAWAI'I - MANOA**

**DECEMBER 10, 2010
8:00 AM - 1:30 PM**

SINCLAIR LIBRARY

SCHEDULE

Sinclair Library

8:00-8:30	Registration Continental Breakfast	Commons
8:30-9:45	Oral Presentations Session 1	108, 110, 201
9:45-10:00	Break	
10:00-11:00	Poster Presentations	301 (Outreach)
11:15-12:15	Oral Presentations Session 2	108, 110, 201
12:15-1:15	Lunch and Award Presentations	301 (Outreach)



Please do not hesitate to inform our staff if you desire particular accommodations.

We will do our best to meet your needs.

SINCLAIR 3RD FLOOR

301 - Poster Presentations

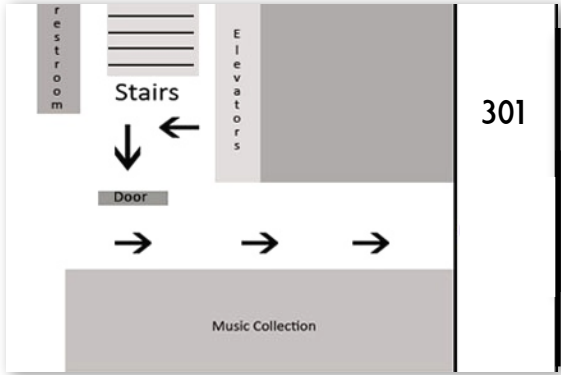

SINCLAIR 2ND FLOOR

201 - Oral Presentations

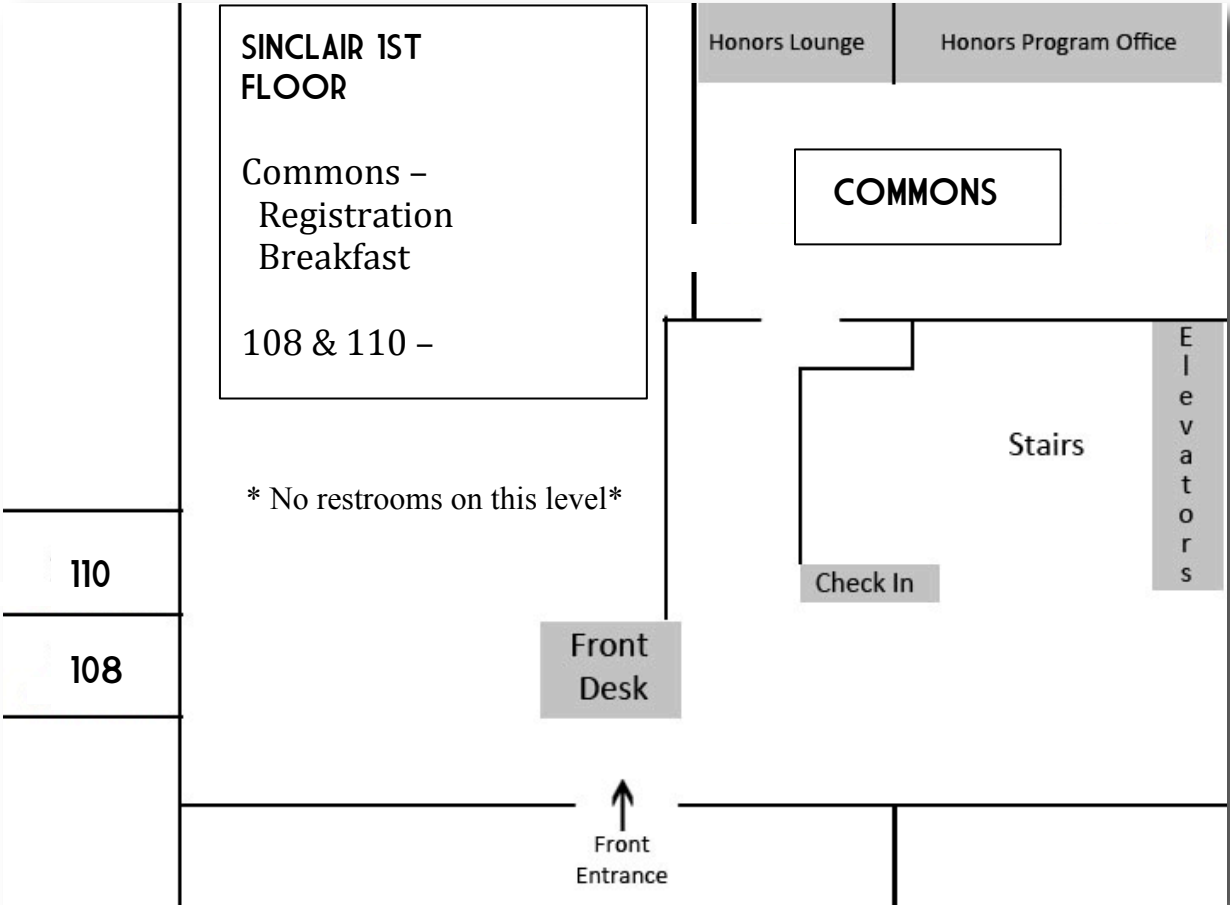
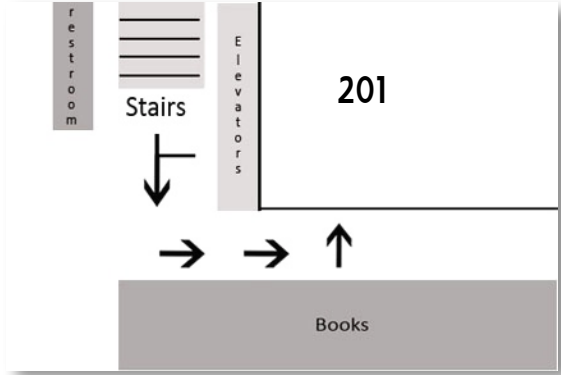

ORAL PRESENTATION SESSION 1
8:30-9:45

SINCLAIR 108 - ARTS & HUMANITIES PROJECT PROPOSALS

- | | | |
|------|----------------------|--|
| 8:30 | Jenna Leigh A. Saito | Screenplay: Two Weeks to Live |
| 8:45 | Tim Dominguez | When I Wake |
| 9:00 | Bonnie Sheehey | Aesthetic Experience of Nature: Dewey, Merleau-Ponty, Zen, and an Aesthetics of Nature |
| 9:15 | Anna Sachs | The Gates of Patriotism |
| 9:30 | Jennifer H. Ohara | “Islamophobia” and the West: Misunderstanding or Incompatibility |

SINCLAIR 110 - SOCIAL SCIENCES FINAL PROJECTS & PROJECTS IN PROGRESS

- | | | |
|------|---------------------|---|
| 8:30 | Nika Nashiro | What’s Going On Behind Those Blue Eyes? The Perceptions of Okinawan Women by U.S. Military Personnel in Okinawa |
| 8:45 | Austin Rochon | At Any Cost: The Passage of President Obama’s Healthcare Reform Bill |
| 9:00 | Christina M. Beyers | Daring to Defy Diabetes: Analysis of Physiological Outcomes in Patients with Type 2 Diabetes Through the Understanding of the Self-Care Model |
| 9:15 | Yi He | International diversification and Financial Performance |

SINCLAIR 201 ARTS & HUMANITIES FINAL PROJECTS & PROJECTS IN PROGRESS

- | | | |
|------|----------------------|---|
| 8:30 | Marissa M.J.A. Chung | Eternal Blinking: A Collection of Poems |
| 8:45 | Janelle Takesono | The Butterfly’s Effect: Portrayals of Japanese Women in Literature from the Continental U.S. and Hawaii |
| 9:00 | Samantha Siefert | If These Walls Could Talk: A Translation of <i>La casa</i> by Manuel Mújica Láinez |
| 9:15 | Daniel J. Bogert | Ukrainian versus Russian Nationalism in the works of Nikolai Gogol |

ORAL PRESENTATION SESSION 2 11:15-12:15
--

SINCLAIR 108 SOCIAL SCIENCES PROJECT PROPOSALS

- | | | |
|-------|---------------|---|
| 11:15 | Scott Perske | So Near Yet So Far: Lesotho, South Africa, and the Millennium Development Goals |
| 11:30 | Max Hamermesh | The effectiveness of fiscal policies during recessions |
| 11:45 | Nicole Cacal | Foreign Business Challenges In China: Case Studies In Shanghai, Beijing And Hong Kong |
| 12:00 | JungYun Chang | Corporate Governance Restructuring Effects – Three Korean Cases (Final Project) |

SINCLAIR 110 NATURAL AND SOCIAL SCIENCES PROJECT PROPOSALS

- | | | |
|-------|-------------------|---|
| 11:15 | Christopher Uyeda | Learning Fractions at Age Six: discrete proportional learning with the aid of continuous stimuli. |
| 11:30 | Kelsey Inouye | Body Language: The Rhetoric of Internal Narratives on Anorexia Nervosa |
| 11:45 | Zachary Williams | An Investigation Into the Biotic Homogenization of Oahu's Stream Fish |
| 12:00 | Scott Campbell | "A Functional Comparison of Human and Neandertal Repetin" |

SINCLAIR 201 PROJECT PROPOSALS WITH TIES TO HAWAII

- | | | |
|-------|--------------------------|---|
| 11:15 | Maria Aurora P. Deguzman | The Influence of the Newspaper Media on Hawaii Statehood Act Referendum Voters: A Case Study on Media Persuasion in Political Communication |
| 11:30 | David Abitbol | The Semiotics of Hawaii's Tourism Industry |
| 11:45 | Christina Lucia Geisse | <i>The Use of Scrolls in Japanese Tea Ceremony and Utsushi: An Ethnographic Study in Hawaii</i> |
| 12:00 | Dara Pagaduan | Type II Diabetes in the Native Hawaiian Population: Exploration of Modernization as Underlying Cause of Poor Diet and Lack of Physical Activity |

**POSTER PRESENTATIONS, SINCLAIR 301
10:00-11:00**

ARTS & HUMANITIES

- Daniel J. Bogert Ukrainian versus Russian Nationalism in the works of Nikolai Gogol
- Marissa M.J.A. Chung Eternal Blinking: A Collection of Poems
- Maria Aurora P. Deguzman The Influence of the Newspaper Media on Hawaii Statehood Act Referendum Voters: A Case Study on Media Persuasion in Political Communication
- Tim Dominguez When I Wake
- Christina Lucia Geisse *The Use of Scrolls in Japanese Tea Ceremony and Utsushi: An Ethnographic Study in Hawaii*
- Jennifer H. Ohara “Islamophobia” and the West: Misunderstanding or Incompatibility
- Dara Pagaduan Type II Diabetes in the Native Hawaiian Population: Exploration of Modernization as Underlying Cause of Poor Diet and Lack of Physical Activity
- Anna Sachs The Gates of Patriotism
- Jenna Leigh A. Saito Screenplay: Two Weeks to Live
- Bonnie Sheehy Aesthetic Experience of Nature: Dewey, Merleau-Ponty, Zen, and an Aesthetics of Nature
- Samantha Siefert If These Walls Could Talk: A Translation of *La casa* by Manuel Mújica Láinez
- Janelle Takesono The Butterfly’s Effect: Portrayals of Japanese Women in Literature from the Continental U.S. and Hawaii

**POSTER PRESENTATIONS, SINCLAIR 301
10:00-11:00**

NATURAL SCIENCES

- Scott Campbell “A Functional Comparison of Human and Neandertal
Repetin”
- Zachary Williams An Investigation Into the Biotic Homogenization of Oahu’s
Stream Fish

SOCIAL SCIENCES

- David Abitbol The Semiotics of Hawaii’s Tourism Industry
- Christina M. Beyers Daring to Defy Diabetes: Analysis of Physiological Outcomes
in Patients with Type 2 Diabetes Through the Understanding
of the Self-Care Model
- Nicole Cacal Foreign Business Challenges In China: Case Studies In
Shanghai, Beijing And Hong Kong
- JungYun Chang Corporate Governance Restructuring Effects – Three Korean
Cases
- Max Hamermesh The effectiveness of fiscal policies during recessions
- Yi He International diversification and Financial Performance
- Kelsey Inouye Body Language: The Rhetoric of Internal Narratives on
Anorexia Nervosa
- Nika Nashiro What’s Going On Behind Those Blue Eyes? The Perceptions
of Okinawan Women by U.S. Military Personnel in Okinawa
- Scott Perske So Near Yet So Far: Lesotho, South Africa, and the
Millennium Development Goals
- Austin Rochon At Any Cost: The Passage of President Obama’s Healthcare
Reform Bill
- Christopher Uyeda Learning Fractions at Age Six: discrete proportional learning
with the aid of continuous stimuli.

ABSTRACTS

Abstracts of paper and poster presentations are listed in alphabetical order of presenter's last name. Information below the name includes the student's major, the purpose of their presentation, the category of their presentation, and whether they are presenting a poster and/or an oral presentation. The faculty mentor, if appropriate, is listed below the abstract.

David Abitbol
Political Science
Project Proposal
Social Sciences

The Semiotics of Hawaii's Tourism Industry

Early in the twentieth century, as businesses in Hawaii became increasingly dependent on tourism, advertisements were used to attract more visitors to the islands. Now, tourism is a vital component of Hawaii's economy and advertisements play an important role in bringing visitors to the Islands. Contemporary advertisements depict Native Hawaiians, the Hawaiian culture, and the Islands of Hawaii in various ways. Some of these depictions portray Hawaii as an exotic paradise with the indigenous peoples as 'noble savages' and 'alluring' hula girls. This paper looks at contemporary advertising images used in select tourist destinations on Oahu as a form of discourse and how they represent and signify Hawaii and its people. These representations can be understood as tropes, or metaphors, that signify Hawaii's 'otherness' to potential tourists and guests. Semiotics, the study of signs and symbols, will be used as a method of inquiry and analysis to assess the tropes and sign functions of these advertisements. Moreover, Edward Said's work on *Orientalism* will be used to evaluate how images as discourse become a source of knowledge and influence for tourists. Through the application of semiotics and *Orientalism*, my research will explore the relationship between advertising images and colonialism in Hawaii.

Mentor: Dr. Sankaran Krishna & Dr. Noenoe Silva

Christina M. Beyers
Biology
Final Project
Social Sciences

**Daring to Defy Diabetes:
Analysis of Physiological Outcomes in Patients with Type 2 Diabetes
Through the Understanding of the Self-Care Model**

Due to the alarming rise in the number of individuals diagnosed with type 2 diabetes, diabetes is now considered an epidemic. Thus, it is essential to study components and factors of the disease to help patients achieve a better quality of life. Consequently, the main objective of this study is to determine if Asian Pacific Islander's (API) who have type two diabetes and have better knowledge and self-management have better Hemoglobin A1c and total cholesterol levels. This question will be analyzed with data previously collected in the parent study and through the use of statistical regressions between knowledge of diabetes and self-management to the dependent variables of HbA1c and total cholesterol. Through the American Association of Diabetes Educators' "Self-Care Behavior Framework" it is proposed that better knowledge leads to better self-management, which affects both psychological and physiological outcomes. The interactive role of self-efficacy in this relationship is not as well known. Two questionnaires were used for assessment, "The Summary of Diabetes Self-Care Activities" and "Diabetes Knowledge Assessment." The questionnaires include components of the modified self-care model, which consist of: general diet, specific diet, exercise, blood-glucose testing, taking medications, foot care and smoking. Consequently, it is predicted that patient's understanding of the components of the self-care model promotes self-management and this may help to improve diabetic related outcomes. The inherent outcome is to increase patient and clinician awareness that self-management is a factor that contributes to better quality of life for patients battling diabetes many behavioral demands.

Mentor: Dr. Jillian Inouye

Daniel J. Bogert
English
Final Project
Arts & Humanities

Ukrainian versus Russian Nationalism in the works of Nikolai Gogol

This essay is a study of the nationalistic sentiment found in the literature of 19th century, Ukrainian author, Nikolai Gogol. The focus of this piece is on Gogol's early adherence to, and veneration of his native Ukraine and his subsequent shift to a tepid brand of Russian nationalism in his later works. The essay provides both historical information about Ukraine, its history, culture, and Gogol's life. Additionally, it contains interpretation and analyses of some of his early short stories. This information is provided in tandem with an analysis of the complex factors that led Gogol to write more about Russian themes, and express muted Russian, rather than bold Ukrainian nationalism in his later works. These include Imperial Russian expansionism, government censorship, the growing group of Russian academics known as the *intelligentsia*, and the Slavic nationalist group known as the Slavophiles.

Mentor: Dr. Virginia Bennett

Nicole Cacal
Finance & International Business
Project Proposal
Social Sciences

Foreign Business Challenges In China: Case Studies In Shanghai, Beijing And Hong Kong

Culture has always influenced the way business is conducted in China. Historically, business and culture have developed alongside one another to create a unique and standardized way of conducting business. China continues to grow and attract more foreign investments as the world's 2nd largest economy in gross domestic product. Foreign businesses have increasingly taken notice in China's inexpensive labor costs, as well as the abundance of skilled labor for lucrative business opportunities. However, before any alliance can successfully be made, foreigners must acknowledge China's culture that has played a significant role in Chinese society for over 5,000 years. In China, interpersonal relationships (*guanxi*) and respect (*mianzi*) are heavily integrated in Chinese business practices. If foreigners are not aware of basic social customs, they are potentially putting their investments at risk. Through the analysis of case studies in international peer-reviewed journals, news articles, and thesis papers, my research will include a comprehensive literature review to find the most important cultural factors for foreigners to understand in order to be considered a successful partner in Chinese business ventures. My study will focus on the areas of Shanghai, Hong Kong, and Beijing, where each area is a major site for globalization. I will also compare the United States and the Arab World's culture with China's cultural similarities and differences. By providing perspectives of two vastly different cultures from dominant world economies, I will provide a guide for those wishing to do business in China so they are able to enhance their business strategies.

Scott Campbell
Microbiology
Project Proposal
Natural Sciences

“A Functional Comparison of Human and Neandertal Repetin”

Proteins determine the functional characteristics of cells, so comparisons between species at the protein level can provide valuable information on the consequences of the genetic changes that cause evolution. The Neandertal genome was recently sequenced by the Neandertal genome project and compared to the human genome. 78 proteins were found to differ significantly from humans, the most different of which is an epidermal skin matrix protein called repetin. This protein is 107 amino acids shorter in humans than in Neandertals. First, relevant research on hominid evolution and on the function and structure of the human repetin gene and protein will be reviewed. The nucleotide and amino acid sequences of human and Neandertal repetin will be compared using the Neandertal Genome Browser. The 3D structures of both proteins will be predicted by protein structure prediction software and aligned to reveal possible structural differences between the two. I will present a method for cloning, isolation, and expression of both alleles based on studies that have previously characterized human repetin. A proposed set of experimental and control groups for the repetin alleles will be presented, along with several possible assays to test functional efficiencies and effects on cell morphology. Isolated repetin will be subjected to several comparative assays based on known characteristics of human repetin. Keratinocytes expressing each repetin allele will be studied to determine the effects of each allele on cell morphology and physiology.

JungYun Chang
Finance
Final Project
Social Sciences

Corporate Governance Restructuring Effects – Three Korean Cases

This paper investigates how the reforms in corporate governance in Korea affect the three Korean conglomerates (*chaebols* in Korean word): Hyundai Group, LG Group, and Samsung Group. The Asian Crisis of 1997 pushed reforms in corporate governance. The Korean government adopted the developed countries' standards of corporate governance, which was Anglo-American corporate governance. By investigating the reforms' influences on the three *chaebols*, this paper checks whether meeting those standards make a Korean company perform better even though each country had developed different economic histories, business cultures, and legal enforcements and law qualities. To see effects of those changes on three *chaebols*, this paper examined the changes in the three companies' Price to Earning (P/E) and Betas of both Korean market premium (β_K). The research paper compares P/E and β_K before the corporate governance reforms to after those changes. As the research is working in progresses, there's no result of a regression model yet. But after running the regression model, the paper will conclude whether different points of each country such as economic development history, culture and legal enforcement can have influence on the adoption of corporate

Mentor: Dr. David Hunter

Marissa M.J.A. Chung
English
Final Project
Arts & Humanities

**Eternal Blinking:
A Collection of Poems**

Initially inspired by my interest in Hawai'i ethnic literature, the poetry I produce sets out to examine Hawai'i as I am discovering it. The players in my work are the people who surround me—family, co-workers, friends. The general settings include the private/public school systems and neighborhoods that I have grown up in, or have come to know. With my Japanese-Korean heritage as a backdrop, I explore the histories of the different generations of my family in Hawai'i. I also experiment writing in Pidgin. Through writing poetry, I am able to make a place for myself, claim an identity as a writer and an individual living in Hawai'i. I write for anyone like me, who attempts to understand the complexity of this place we call home.

Mentor: Dr. Susan M. Schultz

Maria Aurora P. Deguzman
American Studies & Speech
Project Proposal
Arts & Humanities

**The Influence of the Newspaper Media on
Hawaii Statehood Act Referendum Voters:
A Case Study on Media Persuasion in Political Communication**

The overthrow of the Hawaiian Monarchy in 1893 set off a series of events that ultimately resulted in Hawaii becoming the 50th state of the United States. One of the last of these events was a referendum, a vote by residents of Hawaii, on the Hawaii Admission Act that was signed into law by President Eisenhower in 1959. Given only the choice of accepting the act and becoming a state or rejecting it and remaining a territory, the overwhelming majority voted in favor of the act.

More than 50 years later, the topic of Hawaii's statehood remains controversial due in part to a belief that the United States should not have overthrown the Hawaiian Monarchy in the first place. Although many debates about the issues of Hawaiian sovereignty and/or statehood have and continue to take place decades after the fact, one question that has yet to be answered is: what role did the news media play in determining the final outcome of the story?

I hypothesize that the newspaper media influenced the public to vote in favor of the Hawaii Admission Act instead of opting to remain a territory or demanding that the US Government restore the monarchy. Through careful analysis of newspaper articles written about events leading up to and including Hawaii statehood, this study aims to determine how the newspaper media informed the public about the issues of Hawaiian sovereignty and statehood and what influence it may have had on referendum voting.

Mentor: Dr. Jang Kim

Tim Dominguez
English
Project Proposal
Arts & Humanities

When I Wake

My story follows the life of a young man named Gabriel, and his surreal journey into the true final frontier, the depths of the human mind. Growing up with no father to speak of, Gabriel naturally depended on his mother, and they shared a powerful bond. His life would take a dramatic turn for the worst when Gabriel and his mother were struck by a drunk driver late one night. His mother was killed, leaving Gabriel to live with his Grandmother, a curandera, or native medicine woman, who will instill in him invaluable knowledge. Through these difficult years, Gabriel struggles with his loss and seeks an escape in his dream world.

From a very early age, Gabriel had been afflicted by severe night terrors. His mother had taught him that he must confront these hauntings and control them, assuring him that they are nothing more than mere figments of his imagination. Gabriel took this lesson to heart, and discovered his ability to control his dreams, a skill known as lucid dreaming. His ability had never come to its true fruition until the events in Gabriel's life became too much for him to bear. This work explores the dangers of overindulgence and escapism, the power of the human mind and the problems that arise when the symbiotic balance of dreaming and waking life is disturbed. Gabriel's captivating story takes us through an intense journey into an arcane world, often overlooked, and provokes questions about our existence and what defines reality.

Mentor: Dr. Jim Caron

Christina Lucia Geisse
Japanese Language and Literature
Project Proposal
Arts & Humanities

The Use of Scrolls in Japanese Tea Ceremony and Utsushi An Ethnographic Study in Hawaii

The study of Japanese tea ceremony (Chanoyu) in the perspective of *Utsushi*, or the art of copying, has been of interest to current Asian studies research. Practitioners involved in this ritual have historically established strong ties with several art forms, such as pottery, architecture and scrolls. As traditional practices, all these have been handed down from generation to generation, according to strict patterns and rules. In particular, scrolls have not been considerably studied by western academics. By researching how tea ceremony instructors and students in Honolulu, Hawaii, make use of the scrolls, we will understand how contemporary practice embodies *utsushi*, or how the practice might have been transformed to fit contemporary needs, turning into mass production or kitsch. In this way, we can understand how tea ceremony has changed throughout history, in relation to the group of people who currently engage in the practice. The study will be completed in three phases: 1) a thorough review of the literature to understand the historical context of this association, in particular the connections between chado, utsushi and kitsch, 2) an ethnographic approach will be used, which will include interviews with the local practitioners from different tea schools (Urasenke, Omotesenke and Edo-Senke), generating an inventory of the scrolls, and observing regular classes (Keiko) and yearly events (Summer Seminar, Hatsudate and Tsukimi), 3) a comparative literary analysis of the literature and field research will be used to fully understand how the use of scrolls has changed and adapted from historical records to contemporary purpose.

Max Hamermesh
Business Management
Project Proposal

Social Sciences

The Effectiveness of Fiscal Policies during Recessions

A recession is a period of six or more months with negative economic growth measured by gross domestic product (GDP). The United States of America had a total of six recessions since 1970, with the average length being 10.7 months. From December 2007 to June 2009 the U.S. endured the longest recession since the great depression. During the recession, the U.S. experienced a financial crisis, an event that occurred only three other times since 1900 and include the panic of 1907, the great depression, and the 1982 recession. The U.S. uses monetary and fiscal policy as the two primary methods to affect economic growth. Fiscal policy is the use of government spending and taxation to influence the economy. During and after the recession, the U.S. implemented multiple fiscal policy programs, which were intended to increase economic growth and create new jobs. My research will evaluate the effectiveness of two fiscal policy programs, The Consumer Assistance to Recycle and Save Act of 2009 (Cash for Clunker); and the Worker, Homeownership, and Business Assistance Act of 2009 (New Homebuyer Tax Credit) with regards to their ability to positively influence sales figures as well as entice new buyers to the market. Additionally, I will evaluate past and present fiscal policies in a comparative framework regarding their abilities to increase economic growth.

Mentor: Dr. Xiaojun Wang & Dr. Sumner La Croix

Yi He
Finance & minor in Economics
Project in Progress
Social Sciences

International Diversification and Financial Performance

International diversification is an effective tool to reduce risk for some company. However, some companies perform better without international diversification. Some companies perform much better with international diversification. Therefore, there is a model between international diversification and financial performance and a threshold degree of international diversification, below which financial performance gets worse off, while above which financial performance gets better off. In my project, I will develop a model between international diversification and financial performance for Hong Kong market, and obtain the threshold degree of international diversification.

Mentor: Dr. David Hunter

Kelsey Inouye
English & Psychology
Project Proposal
Social Sciences

**Body Language:
The Rhetoric of Internal Narratives on Anorexia Nervosa**

While medical discourses generally tend to support an oversimplification of anorexia nervosa by emphasizing weight, physical complications, and re-feeding, first person narratives on anorexia argue for a much more complex understanding that involves the emotional and psychological experiences underlying starvation. Using rhetorical analysis, I will examine first-person narratives on anorexia—specifically, published autobiographies—in order to demonstrate the interplay between internal (first-person narratives) and external (medical) discourses on the experience of anorexia nervosa. I will focus specifically on two themes that appear consistently in the internal narratives are: perceptions of food and hunger, and anorexic identity. The autobiographies that will serve as primary sources are *Wasted* by Marya Hornbacher, *Biting Anorexia* by Lucy Howard-Taylor, and *Stick Figure* by Lori Gottlieb. Additionally, the assertions made in internal narratives shall be supported by published studies on anorexia nervosa, demonstrating through the convergence of argument and actual behavior, the validity and importance of first person accounts in achieving a fuller understanding of the disease. This examination will demonstrate that despite common external understandings of the anorexia as food and image-oriented, first person narratives argue that anorexia nervosa is a deeply individual experience that cannot be distilled into a pattern of clear causes.

Nika Nashiro
Political Science
Final Project
Social Sciences

**What's Going On Behind Those Blue Eyes?
The Perceptions of Okinawan Women by
U.S. Military Personnel in Okinawa**

How do the GIs stationed in Okinawa perceive Okinawa and Okinawan women? The vast majority of publications about the GIs in Okinawa are written from Okinawans' perspectives portraying GIs as troublemakers who endanger local communities. Frequent cases of sexual assaults of Okinawan women by GIs are well known. However, GIs perspectives in media and other sources are left obscure and the majority of Okinawan women lack knowledge of GIs' views, putting themselves in dangerous situations that results in clashes between individuals that escalate into conflict between countries. In order to obviate these causes, Okinawan women need to be educated about GIs' perspectives and their motivation to their behavior.

This research investigated the GIs' perceptions of Okinawa and Okinawan women at micro and macro level. This study was conducted with combinations of literary studies of colonialism and gender with analyses on 23 interviews with GIs conducted over the summer of 2010.

Through the interview analyses, it was clear that GIs sexualize and feminize Okinawa and Okinawan women. They perceive Okinawa as a woman who needs their help to be protected from the masculine countries around the island. In addition, they view Okinawan women as tools that are sexually accessible to them.

This study provides an alternative perspective that will enhance the knowledge of Okinawan women and will acknowledge the importance of knowing others beforehand in order to prevent any conflict between the parties. In addition to benefiting Okinawan women, the larger community in Okinawa and GIs will also understand GIs' views.

Mentor: Dr. Kathy E. Ferguson

Jennifer H. Ohara
Religion
Project Proposal
Arts & Humanities

**“Islamophobia” and the West:
Misunderstanding or Incompatibility**

Is there a fundamental incompatibility between "The West" and Islam? Many Western cultures are based on the principle of compartmentalization and secularization of different aspects of life, whereas Islam calls itself less a religion and more an entire way of life. I will look at the phenomenon of Islamophobia, which is defined as a general fear or distrust of the Islamic community motivated by ignorance and misrepresentation. I will focus on France and the United States of America as case studies. I will look at recently passed hijab, or Muslim headscarf, and burqa bans in France, as well as the debate over the Park 51 Islamic Center, or Ground Zero Mosque, in the United States.

My research will show the importance of religious tolerance in a West with an increasing Muslim population. I will provide specific background information on Islam, and its relation to the West to provide a foundation for the problems we are currently facing and how these issues fit into the larger scheme of world religions, politics, judiciary practices, international relations, secularism, and women's rights among other things.

My methodology will include literary review of religious texts including an English translation of the Qur'an, Hadith, and Sunna to provide a basic foundation about the principles of Islamic philosophy in contrast with basic assumptions of Western culture. French and United States Constitutional policies regarding religion and secularism will also be reviewed, as well as newspapers, video, governmental policy, and interviews conducted both in person and through online surveys.

Mentor: Dr. James D. Frankel

Dara Pagaduan
Psychology & Hawaiian Language
Project Proposal
Arts & Humanities

**Type II Diabetes in the Native Hawaiian Population:
Exploration of Modernization as Underlying Cause
of Poor Diet and Lack of Physical Activity**

The Native Hawaiian population has the second highest rate of type II diabetes in the United States and the mortality rate is more than double that of non-Hawaiians. Studies have found that poor diet and lack of physical activity lead to increased risk of getting diabetes, which are directly linked to the steady eradication of the traditional Hawaiian diet and culture. Similar effects have proven to be the cause of diabetes in the non-Hawaiian population. However, it is the need for complex carbohydrates in the Native Hawaiian diet as well as the recent exponential increase of the industrialization of the food industry in Hawaii that leads to higher rates of type II diabetes of Native Hawaiians.

Traditional Hawaiian diet programs aim at improving the health of Native Hawaiian adults who have or are at risk of getting diabetes. Over the span of two decades these programs have attempted to improve diet of and encourage physical activity for Native Hawaiian adults, as well as provide education on cultural practices. However, the programs have only proven to provide short-term effects of overall improved health. This leads me to believe that a childhood intervention would be more beneficial.

A survey will be conducted to get college students attitudes toward diabetes, as well as their diet and exercise routines during childhood. This data should provide me with a basis to propose a childhood intervention. The benefit of this study will be to lower the rate of type II diabetes in the Native Hawaiian population.

Mentor: Dr. Maria Chun

Scott Perske
International Relations & World Comparative History
Project Proposal
Social Sciences

**So Near Yet So Far:
Lesotho, South Africa, and the Millennium Development Goals**

In September 2000, the UN outlined eight Millennium Development Goals to address the world's most severe disparities. The Sub-Saharan Africa region has, for decades, suffered the lowest standards of living due mainly to weak governance and economic exploitation. Despite the region's trend of low development, South Africa has maintained levels of economic output comparable to the most highly developed countries of the world. On the other hand, completely surrounded by South Africa lies the small, poor, and land-locked Kingdom of Lesotho, where the total standard of living is much worse. For decades, Lesotho has depended on South Africa for economic opportunities as laborers migrated from Lesotho to South Africa to earn wealth to send back to relatives in Lesotho. The unique relationship between Lesotho and South Africa provides a perfect example to determine whether the wealthy South Africa has not only the responsibility, but the duty to assist the development of Lesotho in the best interest of the entire region. If this is the case, does the need for regional development outweigh South Africa's national economic growth? Do the MDGs bring enough pressure onto wealthy nations to intensify their assistance of under-developed nations? A close observation of both countries' foreign policies will illustrate the extent to which the MDGs influence this particular alliance. This study will analyze the effects of programs that are developed to increase the standards of living in this particular Sub-Saharan Africa region, and provide an example for policy-making in other land-locked developing countries in proximity to wealthier states.

Austin Rochon
Political Science & Economics
Project in Progress
Social Sciences

**At Any Cost:
The Passage of President Obama's Healthcare Reform Bill**

President Barack Obama's Patient Protection and Affordable Care Act, passed in March, 2010, evoked incredibly visceral responses, both in support of and in opposition to the bill. Although public attention focused on climactic phrases such as the "government takeover" of healthcare, "death panels," and the dreaded "nuclear option," the battle for the soul of the legislation was waged behind the closed doors of the White House, where the for-profit health insurance and pharmaceutical industries dominated the debate. Utilizing all the clout at their disposal, those industries substantially influenced the final language of the bill.

Instead of approaching the healthcare reform legislation from a public policy analysis perspective, I will employ a narrative non-fiction approach to unfold the complicated deal-making process. Two examples that I will utilize as models for my work are Michael Lewis' *The Big Short*, and Bob Woodward's *State of Denial*. Both authors deftly utilize narrative non-fiction to explain complex events and processes in way that is accessible to a reader who is not knowledgeable about the topics being covered.

The heart of my research will be a case study on the corruption of our political system. In depicting the enormous influence major health insurance and pharmaceutical industries had on the healthcare bill, my work will serve to exemplify the larger effect special interests have on our political system as a whole. In a government "of the people, by the people, and for the people," special interests ultimately undermine the fundamental tenets of our democracy.

Mentor: Dr. Deborah Halbert

Anna Sachs
Spanish
Project Proposal
Arts & Humanities

The Gates of Patriotism

In light of the increasingly prominent issue of immigration in our country today, I will analyze the various attempts that have been made to address the linguistic debate between Spanish and English within the United States. Due to the changing and growing demographics within this nation, we now face the matter of how to balance the rights of those who reside within the United States, legally and illegally. The English-Only movement attempts to address these shifting demographics. As their name suggests, they push against laws and education in other languages, mainly Spanish, which give many the resources to be an informed and participatory people – one of the requirements for a working democracy.

This paper will primarily discuss what the English-Only movement is. I will also address the various arguments that have been made for and against it as well as suggested laws. Although this paper cannot attempt to cover the complete and vast ramifications of such a movement, it will argue against the cultural intolerance and defective reasoning upon which the movement is based by referring to various professionals within the American linguistic debate. This will be framed within the broader ideas of immigration, education, democracy, and our current political and economic situation in order to gain perspective on possible solutions that would maintain a balance between diversity and equality, while keeping in mind “liberty and justice for all.”

Mentor: Dr. Jim Caron

Jenna Leigh A. Saito
English
Project Proposal
Arts & Humanities

“Two Weeks to Live”

This screenplay is a comedy/drama about a writer who finds himself in the afterlife's Processing Center. In the Processing Center, it's revealed that the writer has died as a result of killing another man. Before being sentenced to Hell, a clerk in the Processing Center intervenes and the judge allows the writer, with the clerk as his guardian, to relive the last two weeks of his life in an effort to uncover what compelled the mild-mannered man to murder. Over the course of time back on earth, he learns that a life worth reliving must be a life lived outside personal comfort zones. Aided by the mentoring of the clerk, the writer learns to take chances and, in the end winds up with a difficult choice. Filled with mayhem, mishaps, and mistaken identities, the man, the clerk, and the writer's middle-aged protege venture to 1970s Las Vegas and become ensnared in the murky underworld of illegal prizefighting.

Through his Vegas adventure, he must confront his own mortality and, thus, the subjective meaning of worthwhile existence. Having spent most of his life analyzing the lives of others as a biographical writer, he's adept at scholarly work but unfamiliar with the world outside his mind. In essence, by not thinking, the writer learns to live.

Mentor: Dr. Glenn Man

Bonnie Sheehey
Philosophy
Project Proposal
Arts & Humanities

**Aesthetic Experience of Nature:
Dewey, Merleau-Ponty, Zen, and an Aesthetics of Nature**

The aesthetic theories of John Dewey and Maurice Merleau-Ponty can be interpreted in terms of an aesthetics of nature, which in turn can serve as a connecting force with Japanese Zen aesthetics. Utilizing Dewey's major treatise on aesthetics, *Art as Experience*, as well as Merleau-Ponty's essays on art, "Cézanne's Doubt" and "Eye and Mind", and D.T. Suzuki's *Zen and Japanese Culture*, I will examine how these works devise their aesthetic theories based on a philosophy of nature, thereby creating what may be called an 'aesthetics of nature'.

Using a Phenomenological-Pragmatic method, I will first outline the basic philosophical assumptions, and aesthetic theories of John Dewey, Maurice Merleau-Ponty, and Zen. Next I will provide examples of art forms influenced by nature from the Western and Zen traditions in order to illuminate these aesthetic theories. These examples will include haiku poetry of Bashō and Buson, the waka poetry of Zen master Dōgen, and sumi-e ink wash paintings of Sesshū and Shūbun from the Muromachi period. From the Western tradition, I will utilize examples from Henry David Thoreau's *Walden*, the poetry of English Romanticist William Wordsworth, and the paintings of Post-Impressionist painter Paul Cézanne. Finally I will discuss certain significant criticisms of these aesthetic theories, and any key differences between them, while still maintaining that a dialogue among all three is essential if we are to deepen and enhance our holistic understanding of each.

Mentor: Dr. Steve Odin

Samantha Siefert
Spanish & Interdisciplinary Studies
Final Project
Arts & Humanities

**If These Walls Could Talk:
A Translation of *La casa* by Manuel Mújica Láinez**

This project is an original translation from Spanish into English of the first chapter of Manuel Mújica Láinez's novel *La casa* (*The House*). The novel is the first-person narrative of a nineteenth-century aristocratic house in Buenos Aires, Argentina, that has been scheduled for demolition and is now reflecting on the events of its life and the lives of its owners, who symbolize different periods of Argentine history. Through this chronicle, Mújica Láinez illustrates the age of decadence followed by the decline of the oligarchy in Argentina in the early twentieth century. His melancholy description and criticism of this era of Argentine development, much of which coincided with his own lifetime, earned the novel the Argentine Writers' Society's *Gran Premio de Honor* in 1955. Today Manuel Mújica Láinez remains a beloved literary figure in Argentina, and *La casa* continues to be praised both for its poetic prose and historical perspective. This project endeavors to share this insightful work of literature with English speakers through the first-ever English translation. The corpus of this project consists of the translation itself with an introduction that includes a summary of the novel, a biography of the author, a summary of relevant historical background, a review of the Translation Studies discipline, and a translator's note.

Mentor: Dr. Lucia Aranda

Janelle Takesono
English & History
Project in Progress
Arts & Humanities

**The Butterfly's Effect:
Portrayals of Japanese Women in Literature
from the Continental U.S. and Hawaii**

When Commodore Matthew Perry opened the ports of Japan in 1852, his writings influenced how the rest of the world would come to view Japan. These images were reflected in Giacomo Puccini's famous 1904 opera, *Madame Butterfly*, in which Butterfly, the main character, takes little control of her life. This "butterfly" personification influenced how Japanese women have been portrayed in literature ever since. My thesis will examine whether or not Japanese women in literature from the continental United States and Hawaii reflect that image. I believe that literature published during the 1990s from the continental United States does follow this stereotype, but literature from Hawaii does not.

I will analyze the historical context of *Madame Butterfly* by looking at the writings of Commodore Perry and use literary analysis to examine the portrayal of Butterfly in Puccini's opera. Next, I will examine whether or not literature from the 1990s reflects stereotypes from *Madame Butterfly*. First, I will analyze novels from the continent, such as *Memoirs of a Geisha* by Arthur Golden and *Snow Falling on Cedars* by David Guterson. Then I will juxtapose these novels with literature from Hawaii, such as, *Name Me Nobody* by Lois Ann Yamanaka and short stories from Bamboo Ridge Press.

By analyzing the stereotypes of Japanese women from Hawaii and the rest of the U.S, this project will lead to a better understanding of cultural differences. Furthermore, much has been written on Japanese women and local literature separately, but not many comparative works have been done.

Mentor: Dr. Jim Caron

Christopher Uyeda
Psychology
Project Proposal
Social Sciences

Learning Fractions at Age Six: Discrete Proportional Learning with the Aid of Continuous Stimuli

Math learned early in life, specifically around six years of age, has a drastic impact on future mathematical performance. Fractions are an especially difficult area for children to master. Taking this into account, fractions should be addressed as early as possible to mitigate problems that may develop later on. Classical cognitive developmental theory indicates that children do not acquire the ability to perform proportional manipulations until the formal operational stage of development at around ten to twelve years of age. However, recent evidence suggests that this is not the case and, in fact, children as young as six can reason proportionally. This discrepancy between early and recent results can be explained through the use of discrete and continuous representations. This is to say that children at six years of age only perform poorly when experiments use discrete representations and perform well with continuous representations. While these results are important they don't completely solve the problem of teaching children fractions at a young age, for fractions in the classroom are represented in a discrete fashion. It's therefore suggested that an experiment be carried out to examine the impacts of continuous representations on discrete proportional learning in six year olds. This will be accomplished by comparing the performance of a control that is only exposed to discrete representations and an experimental group that is administered a battery that is supportive of analogical transfer in the hopes that the concept of continuous proportionality will generalize to discrete proportionality.

Zachary Williams
Zoology
Project Proposal
Natural Sciences

An Investigation Into the Biotic Homogenization of Oahu's Stream Fish

Invasions are characterized by the process of introduced species, often generalists, placing competitive pressure on native species, which often results in a reduction of native populations and an increase in the population and distribution of the nonnative. The cumulative effect of this is a loss of unique native species as they are replaced by competitively superior exotic species, leading to an overall loss in species diversity globally. This process of replacement is known as biotic homogenization, and is a major factor in global environmental change today. On an island such as Oahu, the fragility and naivety of native fauna increases their susceptibility to invasion. Among the Hawaiian Islands Oahu is the most urbanized, this has resulted in the alteration and destruction of habitat, as well as introduction of nonnative flora and fauna. The repercussions on the local ecosystem is clearly evident, a reduction or loss of habitat and native species. Five such native species reside in Oahu's streams, the native gobies, and the ramifications of urbanization have led to their decline. Taking these native's place are a number of exotic freshwater fish from across the globe, introduced both intentionally and accidentally by way of aquaculture, sport fishing, and the aquarium hobby. I propose an investigation into the biotic homogenization on the island of Oahu using these freshwater fish. By collecting data on species diversities and distributions within Oahu's numerous streams, and by calculating the similarities among distinct watersheds, the degree to which homogenization has occurred may be better understood.

ACKNOWLEDGEMENTS

FACULTY MENTORS

We would like to acknowledge the time, effort and expertise that faculty mentors put into advising students on their projects. Thanks to the following for their hard work:

Dr. Lucia Aranda
Dr. Virginia Bennett
Dr. James Caron
Dr. Maria Chun
Dr. Kathy E. Ferguson
Dr. James D. Frankel
Dr. Debora Halbert
Dr. Ku'ualoha Ho'omanawanui
Prof. David Hunter
Dr. Jillian Inouye
Dr. Jang Kim
Dr. Ehito Kimura
Dr. Sankaran Krishna
Dr. Sumner La Croix
Dr. Glenn Man
Dr. Steve Odin
Dr. Susan M. Schultz
Dr. Noenoe Silva
Dr. Frank Stewart
Prof. Xiaojun Wang

ACKNOWLEDGEMENTS

FACULTY JUDGES AND MODERATORS

We would like to thank all the faculty members and instructors who volunteered to judge and moderate the sessions and to lend their experience and expertise to this student conference.

Dr. Lucia Aranda
Dr. David Ashworth
Dr. Ann Auman
Dr. Abby Collier
Dr. Qi Chen
Dr. Cynthia Hunter
Dr. Jillian Inouye
Dr. Laura Lyons
Dr. Thomas Pearson
Dr. Traci Sylva
Dr. Audrey Thevenon

STUDENT VOLUNTEERS

The Honors Program would like to thank the Honors students who helped to plan, set up, and take down the facilities and to monitor the rooms during sessions.

STAFF

The organizers would like to extend a special thank you to their respective office staff for all their hard work behind the scenes during the conference and throughout the year.

SPECIAL THANKS

Thanks to Gregg Geary and Suzie Samuel for our partnership with Sinclair Library, and assistance in planning.

Thanks to Salim Mohammed, Christie Pang, and rest of the MAGIS team for accommodating our poster printing needs.

Thanks to Ako Kifuji and Ahmed Ramadan for the lunch catering from Da Spot.



the
Honors
Program



**HONORS PROGRAM
UNIVERSITY OF HAWAI'I - MANOA**

**DECEMBER 10, 2010
8:00 AM - 1:30 PM**

SINCLAIR LIBRARY

SCHEDULE

Sinclair Library

8:00-8:30	Registration Continental Breakfast	Commons
8:30-9:45	Oral Presentations Session 1	108, 110, 201
9:45-10:00	Break	
10:00-11:00	Poster Presentations	301 (Outreach)
11:15-12:15	Oral Presentations Session 2	108, 110, 201
12:15-1:15	Lunch and Award Presentations	301 (Outreach)



Please do not hesitate to inform our staff if you desire particular accommodations.

We will do our best to meet your needs.

ACKNOWLEDGEMENTS

FACULTY JUDGES AND MODERATORS

We would like to thank all the faculty members and instructors who volunteered to judge and moderate the sessions and to lend their experience and expertise to this student conference.

Dr. Lucia Aranda

Dr. David Ashworth

Dr. Ann Auman

Dr. Abby Collier

Dr. Qi Chen

Dr. Cynthia Hunter

Dr. Jillian Inouye

Dr. Laura Lyons

Dr. Thomas Pearson

Dr. Traci Sylva

Dr. Audrey Thevenon

STUDENT VOLUNTEERS

The Honors Program would like to thank the Honors students who helped to plan, set up, and take down the facilities and to monitor the rooms during sessions.

STAFF

The organizers would like to extend a special thank you to their respective office staff for all their hard work behind the scenes during the conference and throughout the year.

SPECIAL THANKS

Thanks to Gregg Geary and Suzie Samuel for our partnership with Sinclair Library, and assistance in planning.

Thanks to Salim Mohammed, Christie Pang, and rest of the MAGIS team for accommodating our poster printing needs.

Thanks to Ako Kifuji and Ahmed Ramadan for the lunch catering from Da Spot.